

1 Use drill guide (P/N: FJ-DRILL) to ensure pilot hole is drilled perpendicular to the rafter

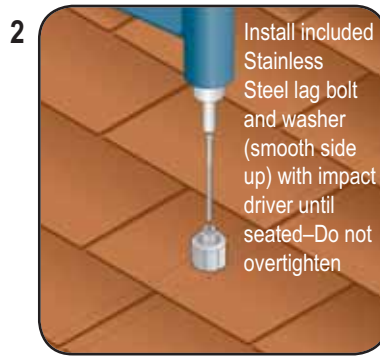

2 Install included Stainless Steel lag bolt and washer (smooth side up) with impact driver until seated—Do not overtighten

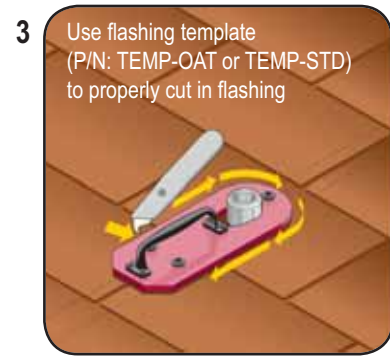

3 Use flashing template (P/N: TEMP-OAT or TEMP-STD) to properly cut in flashing

### Steps 4–6 for Oatey® flashings only

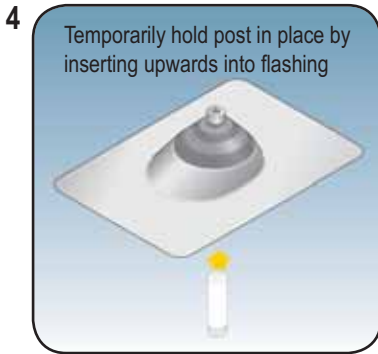

4 Temporarily hold post in place by inserting upwards into flashing



5 Insert flashing, aligning post and base

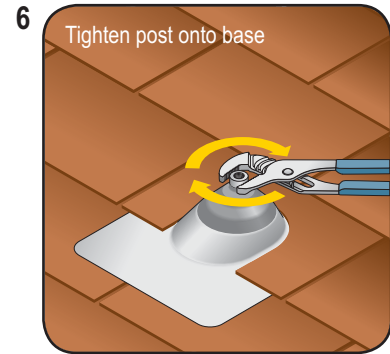

6 Tighten post onto base

### Steps 7–9 for standard metal flashings only

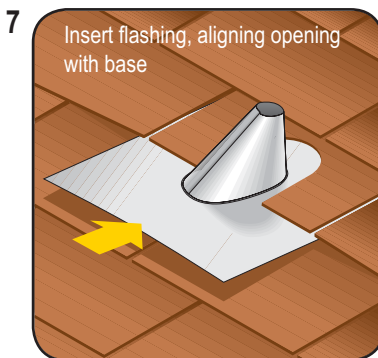

7 Insert flashing, aligning opening with base

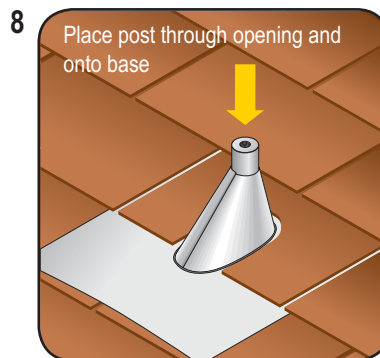

8 Place post through opening and onto base

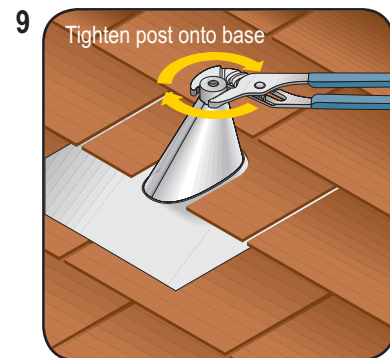

9 Tighten post onto base

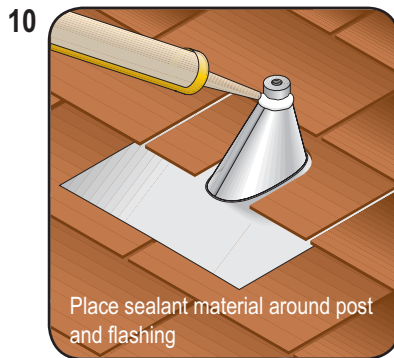

10 Place sealant material around post and flashing



**Commercial FastJack® E-series**  
 Lab tested to 4,050 lbs vertical pullout\*  
\*Using 3/8" x 4" SS lag bolt (not included). 1,875 side axial pullout.

**Two Sizes Available**

<b>4" High</b>	<b>Part# CFJE-400-18</b>
Post top threaded for standard 3/8" bolt, 2" round base, accepts 3/8" lag bolt	
<b>6" High</b>	<b>Part# CFJE-600-18</b>
Post top threaded for standard 3/8" bolt, 2" round base, accepts 3/8" lag bolt	

Box includes:  
 (18) 1-1/4" Solid Aluminum Posts  
 (18) 2" Aluminum Bases

## Accessories



**Flashing Template**  
 Makes cutting in flashing easy and accurate. Available in two sizes for Oatey® (Part# TEMP-OAT) shown and standard metal flashings (Part# TEMP-STD).



**Drill Guide**  
 Helps ensure proper pilot hole drilling. Includes both drill guides for FJE (3/16") and CFJE (1/4") product lines. (Part# FJ-DRILL)



**Clear Flashing**  
 Low profile, UPC, NES 653 approved.  
 Color: clear (Part# OAT-SF)



**Black Flashing**  
 Low profile, UPC, NES 653 approved.  
 Color: black (Part# OAT-SF-B)