

SIM-SUPPORT BRACKET

Our Products: [Roof Type](#)

APPLICATION:

Our SIM-SUPPORT bracket with center lift utilizes 2 of our patented watertight Simple Seal bushings, and was engineered to be used on metal corrugated roofing, with fastener spacing that allows for two fasteners per metal purlin. Measures 3" L x 1" W x 1 23/50" H (including 3/8" - 16 Stud).

COMPATIBILITY:

- Stand-alone product

AVAILABLE FINISHES:

- Mill Finish (Standard)
- Black Anodized

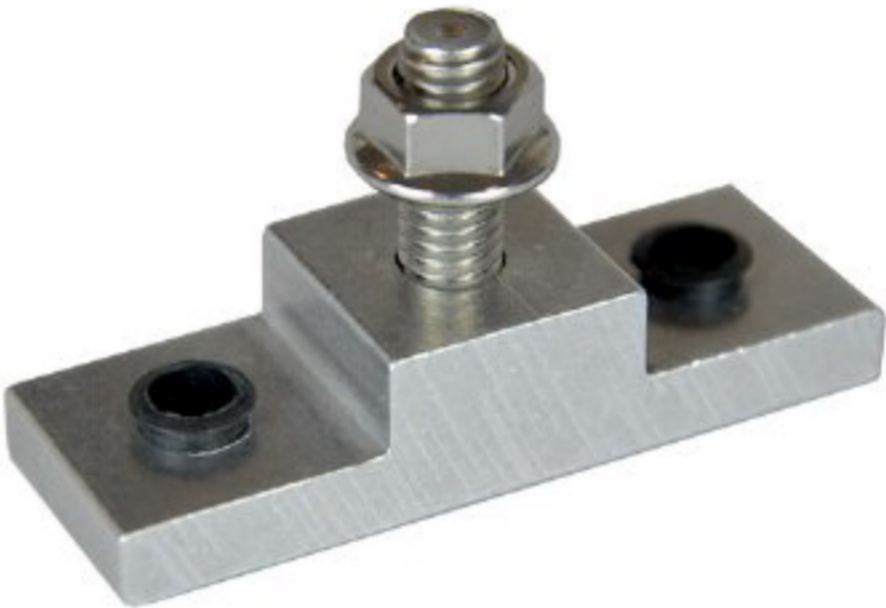

Cut Sheet - SIM-Support

1. Installation to be completed in accordance with manufacturer's written specifications and installation instructions.
2. See spec sheet or contact manufacturer for detailed material, finishes, and configuration options.
3. Contact manufacturer for detailed layout.
4. Do not scale drawings.
5. Subject to change without notice.

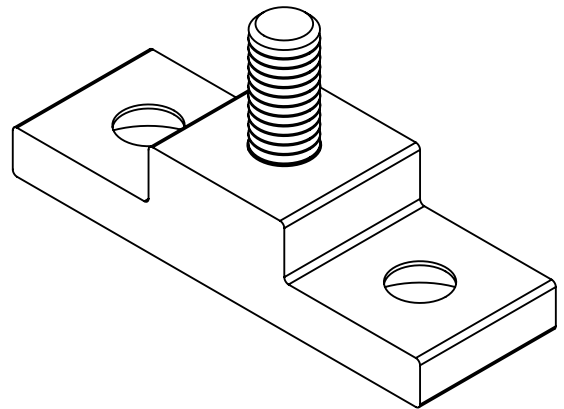
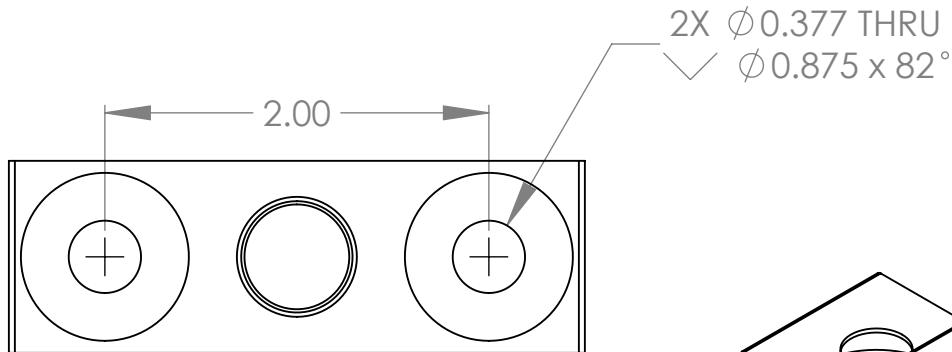
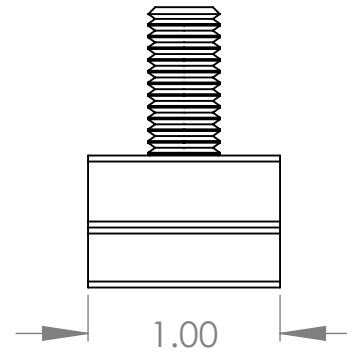
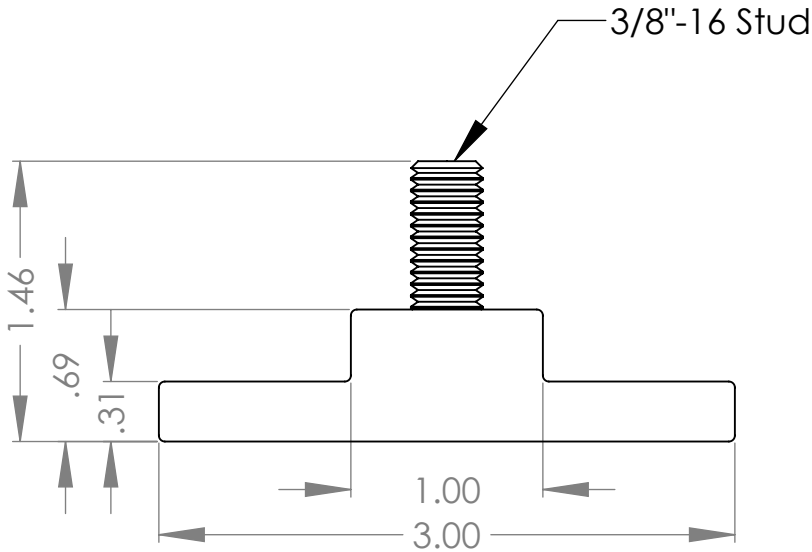

**ALPINE
SNOWGUARDS®**
www.alpinesnowguards.com

Toll Free Phone 1.877.479.9765
Toll Free Fax 1.888.766.9994



EcoFasten Solar®
www.ecofastensolar.com

Toll Free Phone 1.877.859.3947
Toll Free Fax 1.888.766.9994

289 Harrel Street
Morrisville, VT 05661

Material: See Spec Sheet

Scale: 1:1

05/02/2013

ASG: X

EFS: X

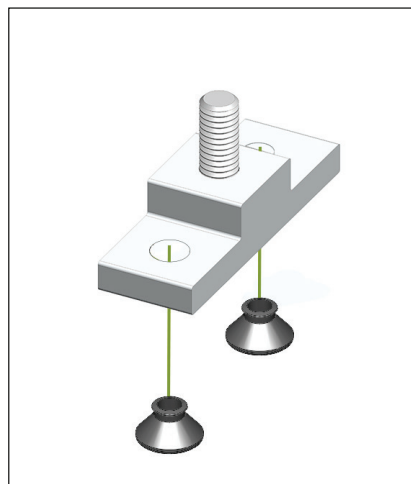
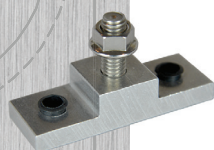

1

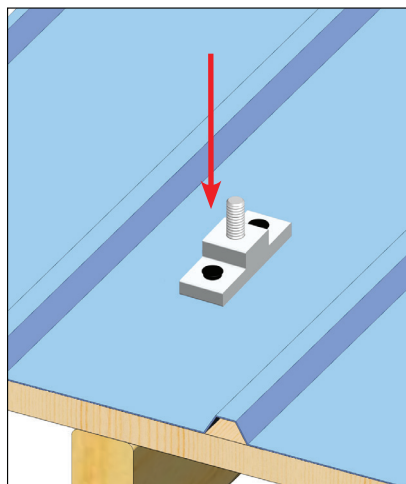

2

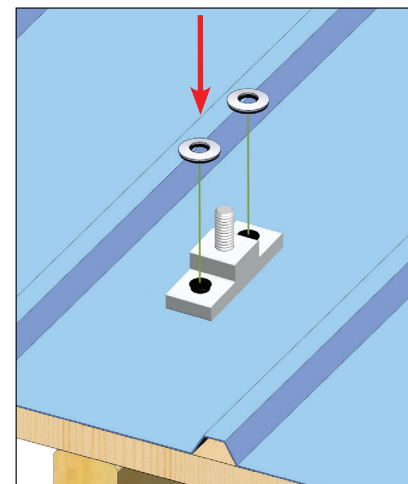

3

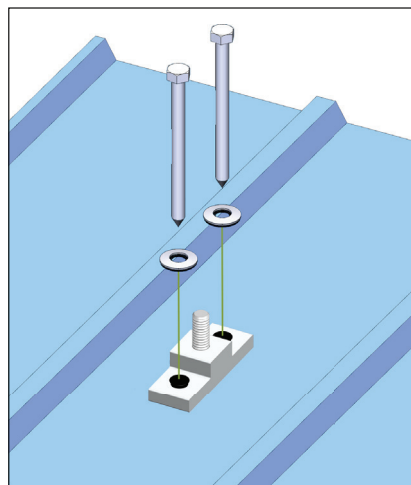

4

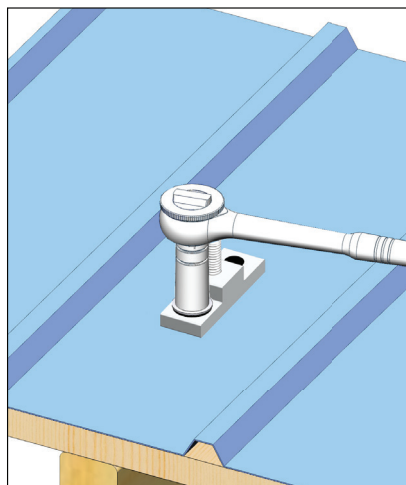

5

Instructions

1. The cone shaped bushings are black in color and are packaged with the compression bracket. Insert these bushings into the bracket prior to installation. To do this, insert the tip of the cone into the corresponding shape in the bottom of the compression bracket. The ridge around the tip of the cone will hold the bushing in place until the bracket is installed.
2. Place the compression bracket on roof surface above a supporting structural component, ensuring that the bushings sit flat against the roof surface.
3. Place the bonded EPDM/stainless steel washers over the exposed portion of the bushings, EPDM side down.
4. Insert the fasteners that have been pre-approved for the project through the bonded washer and the bushings.
5. Tighten fasteners until bracket is pulled down snug to the roof surface. The tension required will vary with the project roof deck, age, and type. Be sure not to over tighten the fasteners and strip the threads.

Assembly Sheet - SIM-Support

1. Installation to be completed in accordance with manufacturer's written specifications and installation instructions.
2. See spec sheet or contact manufacturer for detailed material, finishes, and configuration options.
3. Contact manufacturer for detailed layout.
4. Do not scale drawings.
5. Subject to change without notice.

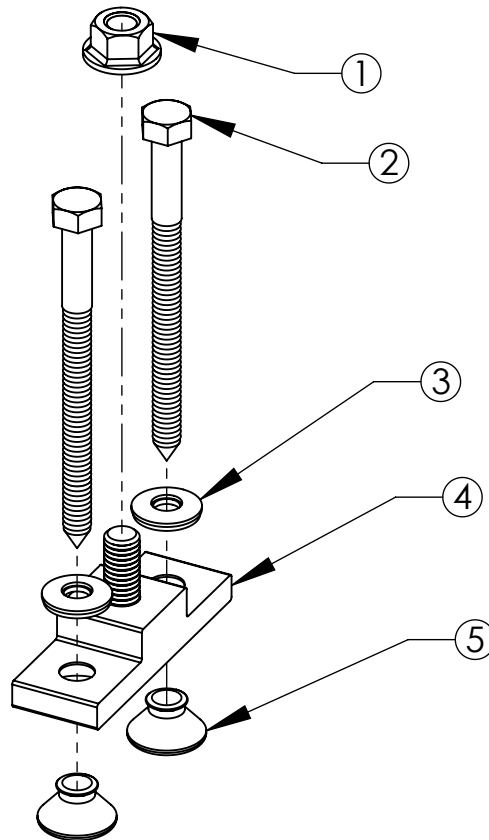

ITEM NO.	DESCRIPTION	QTY.
1	3/8-16 Hex Head Flange Nut 18.8 SS	1
2	5/16" Diameter Shank Approved Fastener	Not Included
3	5/16 EPDM/SS Bonded Washer	2
4	SIM-Support Bracket	1
5	Simple Seal Bushing	2



Toll Free Phone 1.888.766.4273
Toll Free Fax 1.888.766.9994



Toll Free Phone 1.877.859.3947
Fax 1.602.272.4668

289 Harrel Street 4741 W. Polk St., Ste. 4
Morrisville, VT 05661 Phoenix, AZ 85043

Material: See Spec Sheet

Scale: 1:2 11/18/2016 ASG: X EFS: X