

NOTES:

1. PART TO BE MANUFACTURED TO ALUMINUM ASSOCIATION STANDARD TOLERANCES UNLESS OTHERWISE STATED
2. ALL DIMENSIONS +/- .015, +/- 2° UNLESS OTHERWISE STATED
3. REFER TO CAD MODEL FOR DIMENSIONS NOT SHOWN
4. USE PART SYMMETRY
5. ALL RADII .010 [0.25] UNLESS OTHERWISE STATED
6. DEBURR ROUGH EDGES (NO HANGING BURR)
7. CRITICAL DIMENSIONS IN **BOLD**

REVISION:			
A	11/30/2020	NEW ITEM	DR
B	2/2/2021	NU001175	MKW
C	9/7/2021	NU002165	MKW
D	4/10/2023	NU004706	MKW

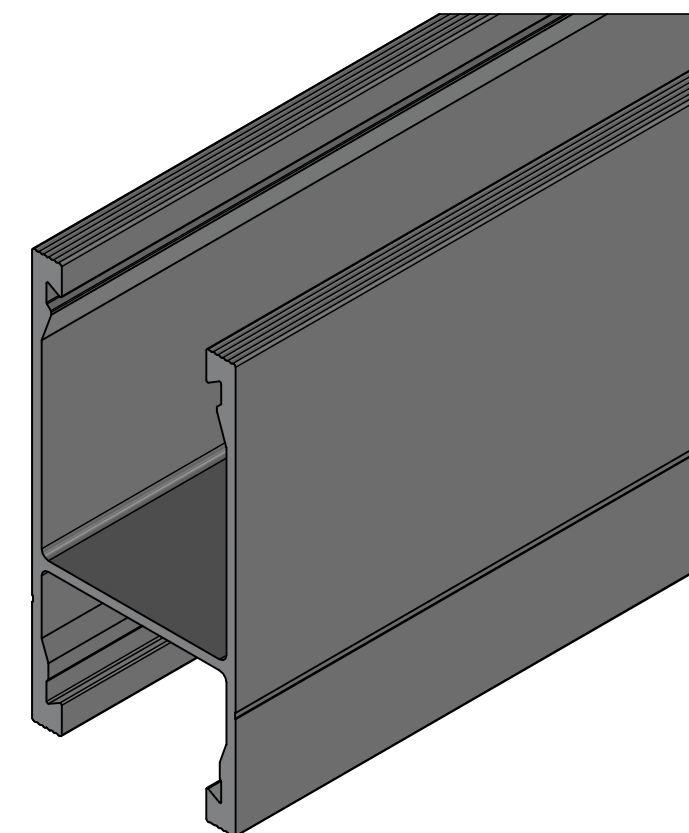

ISO

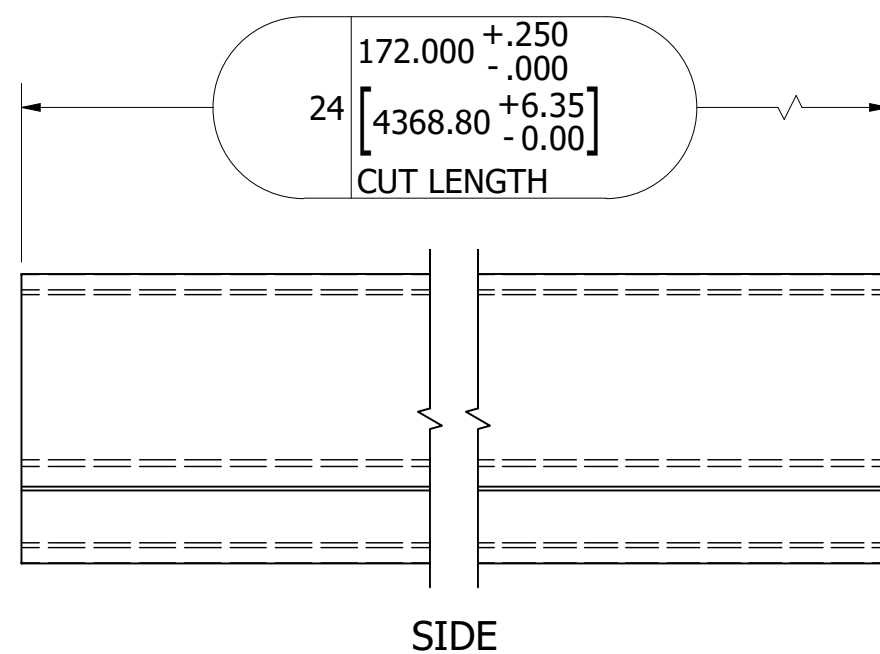

SIDE

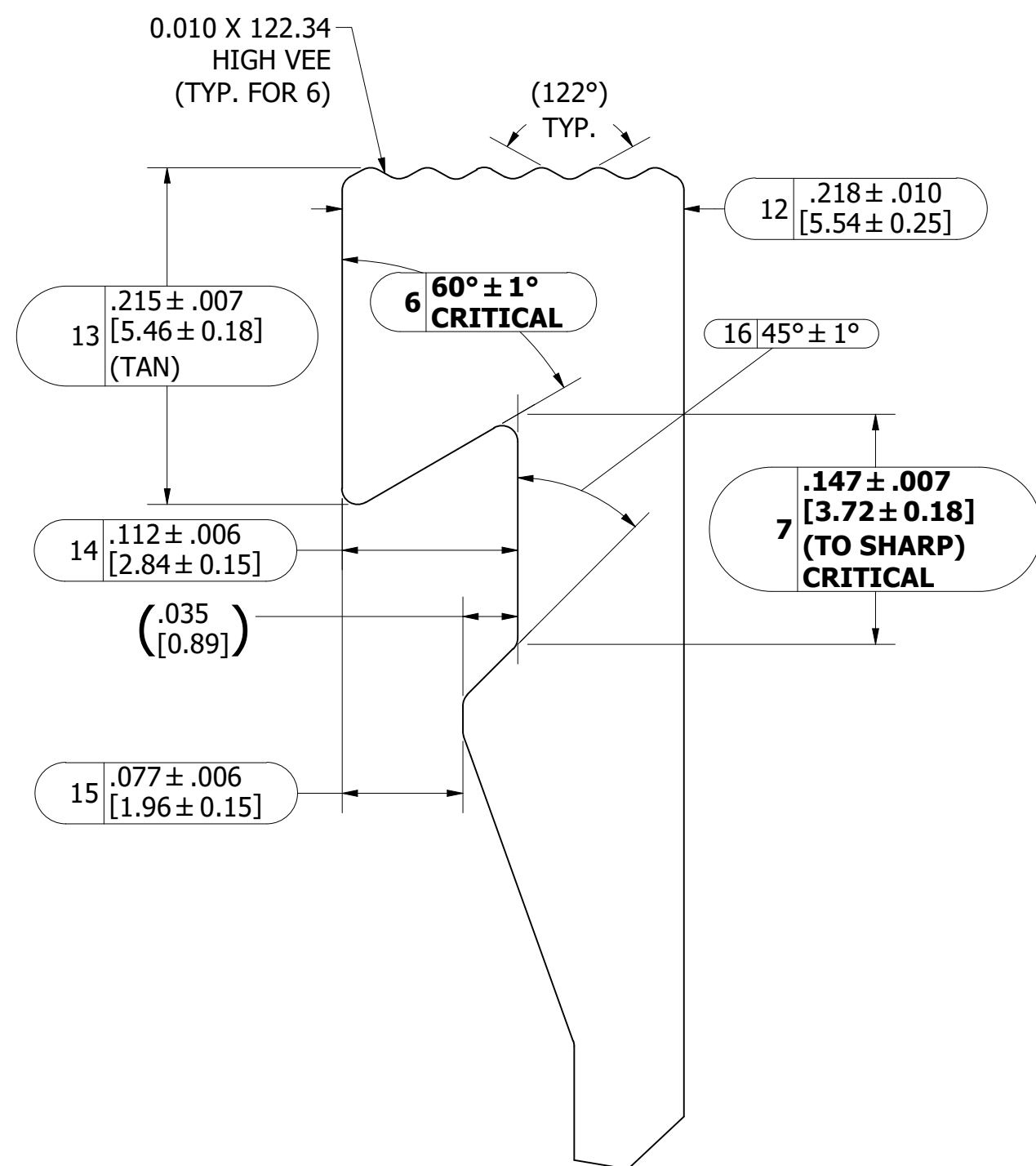

DETAIL A, TOP CHANNEL NUT RETENTION FEATURE

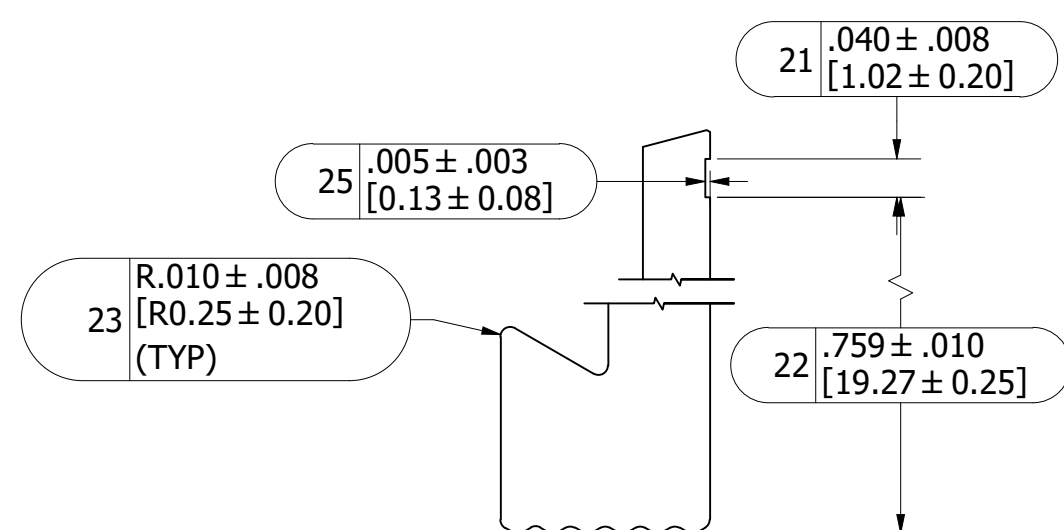

DETAIL C, DRILL GUIDE

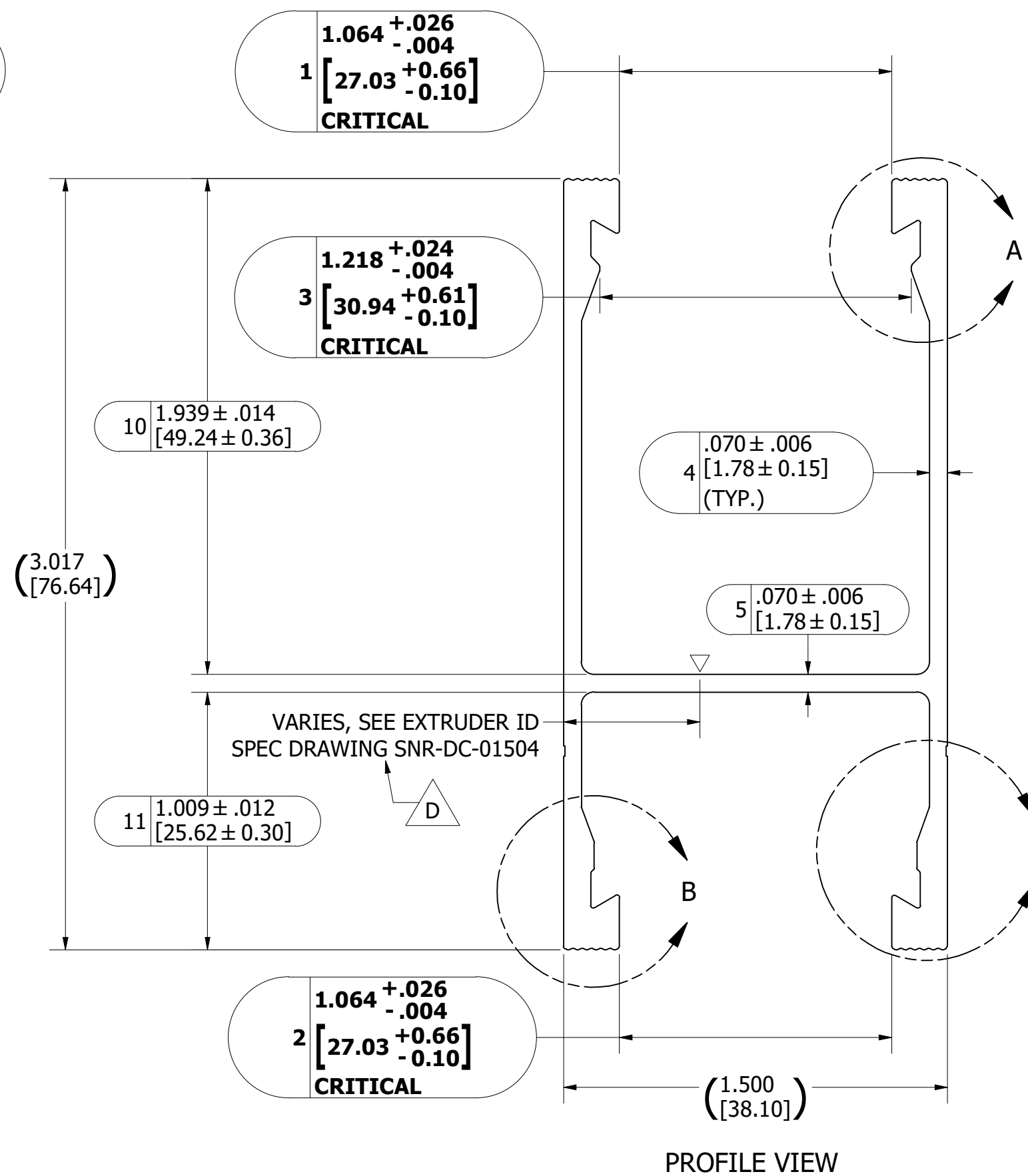

PROFILE VIEW

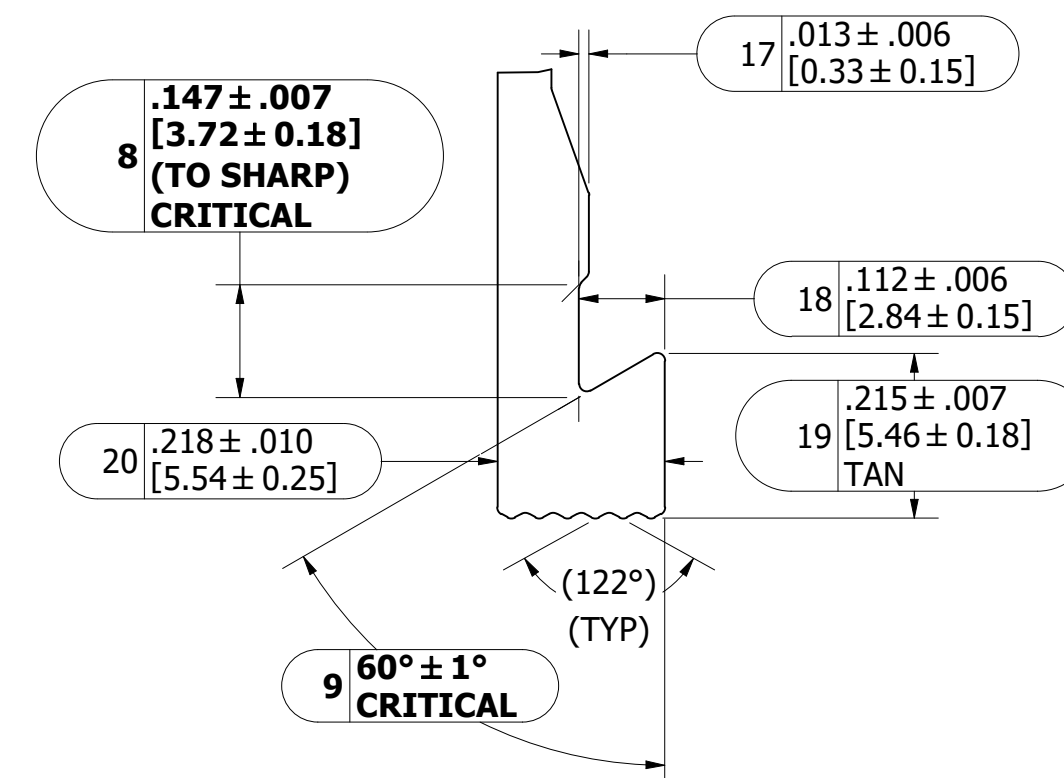

DETAIL B, BOTTOM CHANNEL NUT RETENTION FEATURE

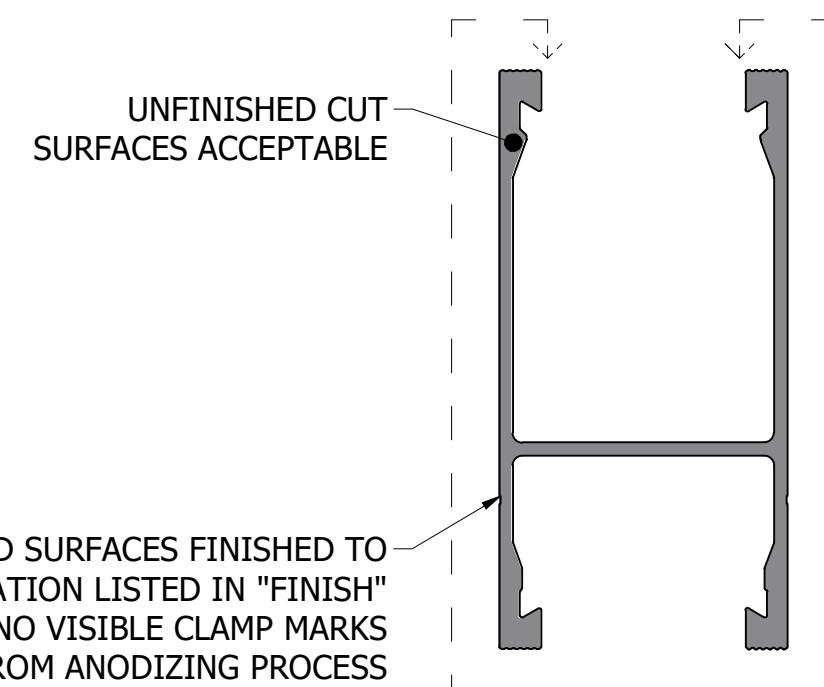

EXPOSED SURFACES

▽ EXTRUDER ID MARK



SUNRUN INSTALLATION SERVICES INC.
225 BUSH STREET, SUITE 1400 • SAN FRANCISCO, CA 94104 USA
PHONE (877) 732-2860 • CONTACT@SNAPNRACK.COM
THE INFORMATION IN THIS DRAWING IS CONFIDENTIAL AND PROPRIETARY. ANY REPRODUCTION, DISCLOSURE, OR USE THEREOF IS PROHIBITED WITHOUT THE WRITTEN CONSENT OF SNAPNRACK.

DESIGNER: G.MCPHEETERS
DRAFTER: M.WATKINS
APPROVED BY: W.ARBUCKLE

SHEET NUMBER: 1:1
SHEET SIZE: C

SCALE: DNS
DATE: 4/10/2023

MATERIAL: EXTRUDED: 6005-T5 ALUMINUM, PER ASTM B221
UNITS OF MEASURE: IN, LB, DEG [MM, KG, DEG]

FINISH: ANODIZED TO AA-M12C22A31, CLEAR

DESCRIPTION: SNAPNRACK, GROUND RAIL, 172IN, SILVER

PART NUMBER: 232-02542

PART WEIGHT: 11.518 lbmass
REV: D