

PARTS LIST

ITEM	QTY	PART NUMBER	DESCRIPTION
1	1	232-02259	SNAPNRACK SEAM CLAMP CAM
2	1	232-02260	SNAPNRACK SEAM CLAMP INSERT
3	1	165-02201	WASHER, LOCK, 5-16IN, SPLIT, BLACK, SS
4	1	162-01067	5-16IN-18 X 1-1-2IN SS HCS BOLT BLACK
5	1	232-02257	SNAPNRACK, SEAM CLAMP WIDE BASE, CLEAR
6	1	162-03252-S	BOLT, FLANGE, SERRATED, 5-16IN-18 X 2IN, SS
7	1	232-02465	SNAPNRACK, ULTRA RAIL MOUNT TAPPED PRC, CLEAR
8	1	232-02462	SNAPNRACK, ULTRA RAIL MOUNT THRU PRC, CLEAR
9	1	232-02521	SNAPNRACK, RL UNIVERSAL, MOUNT SPRING, SS
10	1	232-02534S	SNAPNRACK, AP90 L FOOT, STEPPED, CLEAR
11	1	165-01300	5-16IN X 3-4IN SS FLAT WASHER
12	1	232-02052	SNAPNRACK, SEAM CLAMP ROTATION LOCK

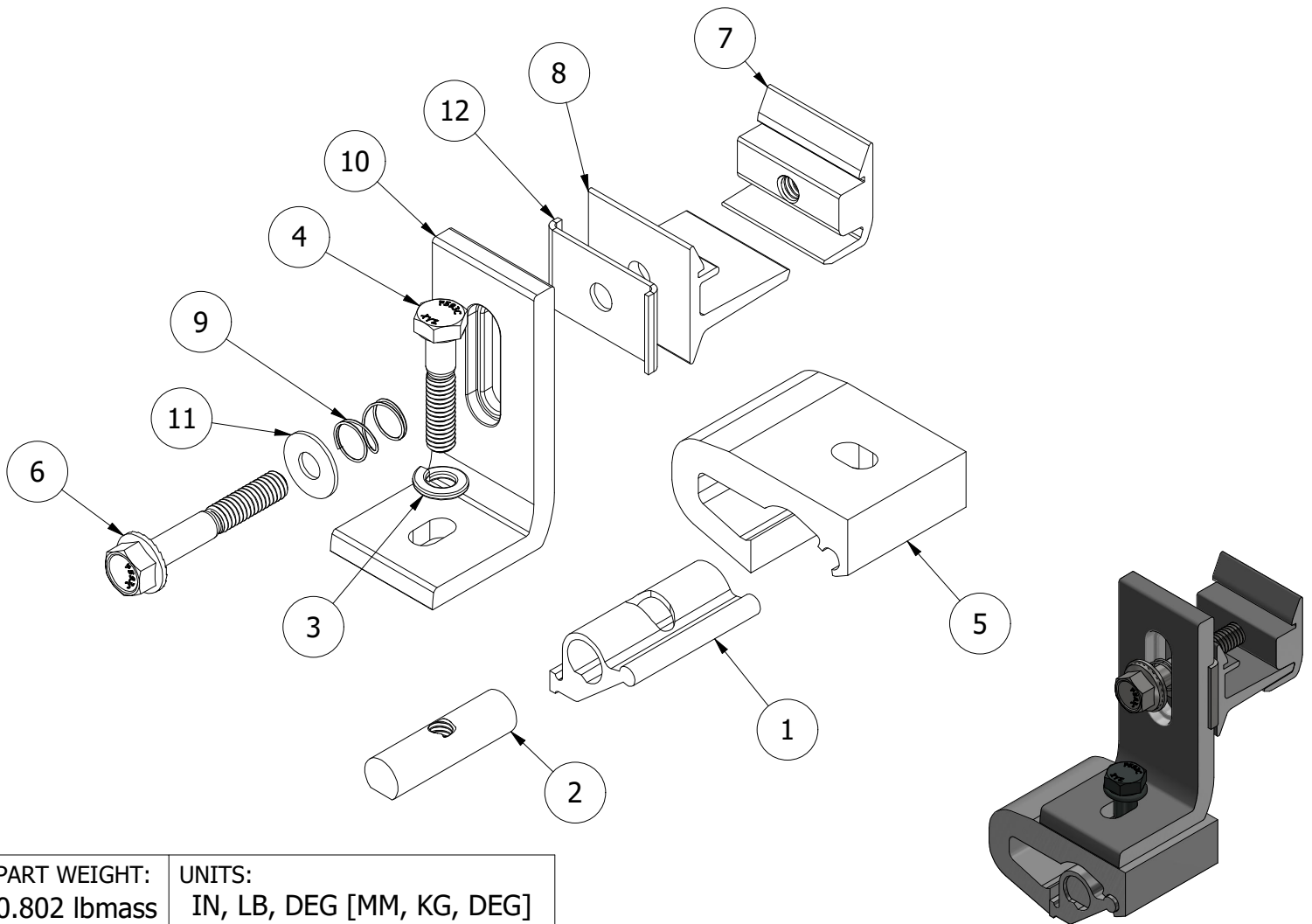

PART WEIGHT: 0.802 lbmass  
 UNITS: IN, LB, DEG [MM, KG, DEG]

DESCRIPTION:  
 SNAPNRACK, ULTRA RAIL WIDE BASE SEAM CLAMP WITH L FOOT AND LOCK

DRAWN BY: M.AFFENTRANGER

APPROVED BY: W.ARBUCKLE

REVISION:

A	11/8/2018	NEW ITEM	DR
B	7/27/2020	NU001113	MJA
C	4/28/2022	NU003089	DR

**SnapNrack™**  
**Solar Mounting Solutions**

SUNRUN INSTALLATION SERVICES, INC.

PART NUMBER:  
 242-05159

SCALE:  
 DNS

REV:  
 C

225 BUSH STREET, SUITE 1400 • SAN FRANCISCO, CA 94104 USA  
 PHONE (877) 732-2860 • CONTACT@SNAPNRACK.COM

THE INFORMATION IN THIS DRAWING IS CONFIDENTIAL AND PROPRIETARY. ANY REPRODUCTION, DISCLOSURE, OR USE THEREOF IS PROHIBITED WITHOUT THE WRITTEN CONSENT OF SUNRUN SOUTH LLC.