

REVISION:			
A	3/24/2015	NEW ITEM	DR
B	2/9/2023	NU004542	MJA

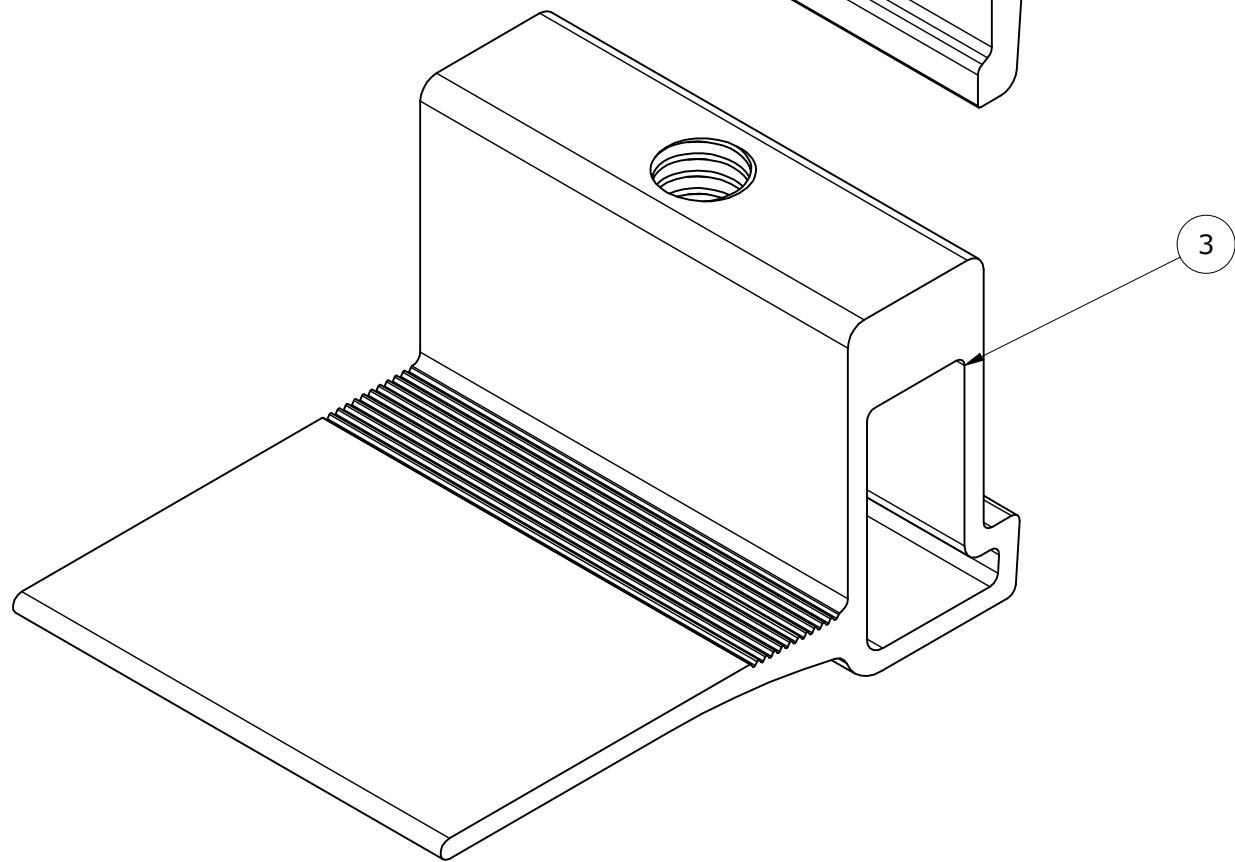

EXPLODED

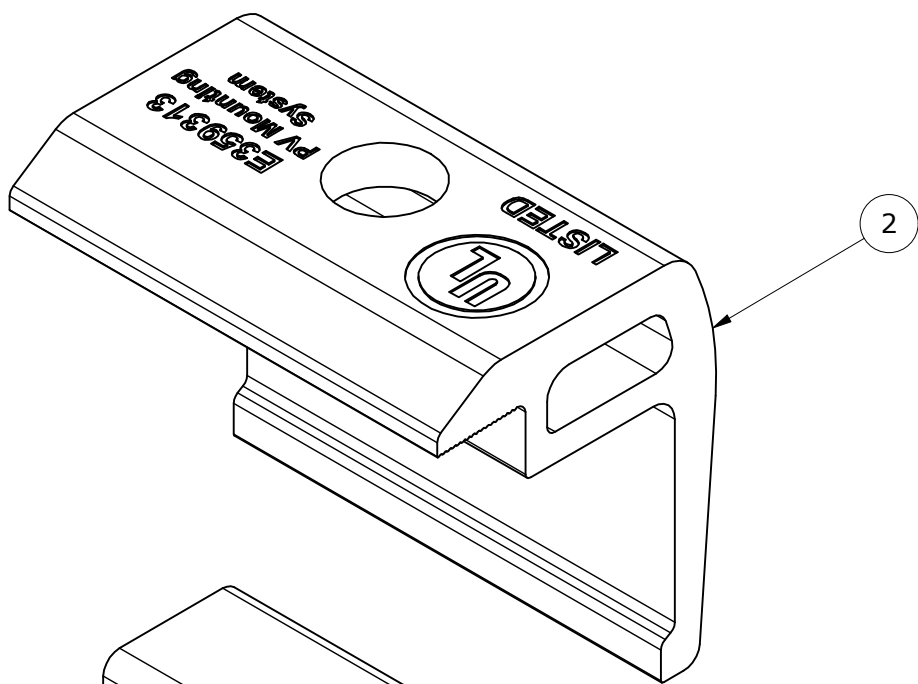
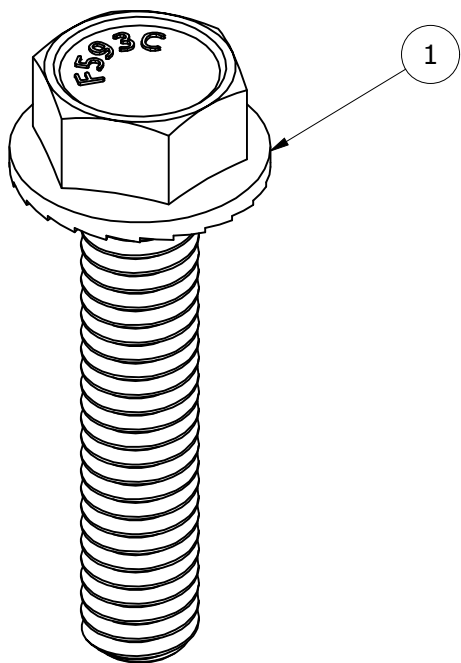
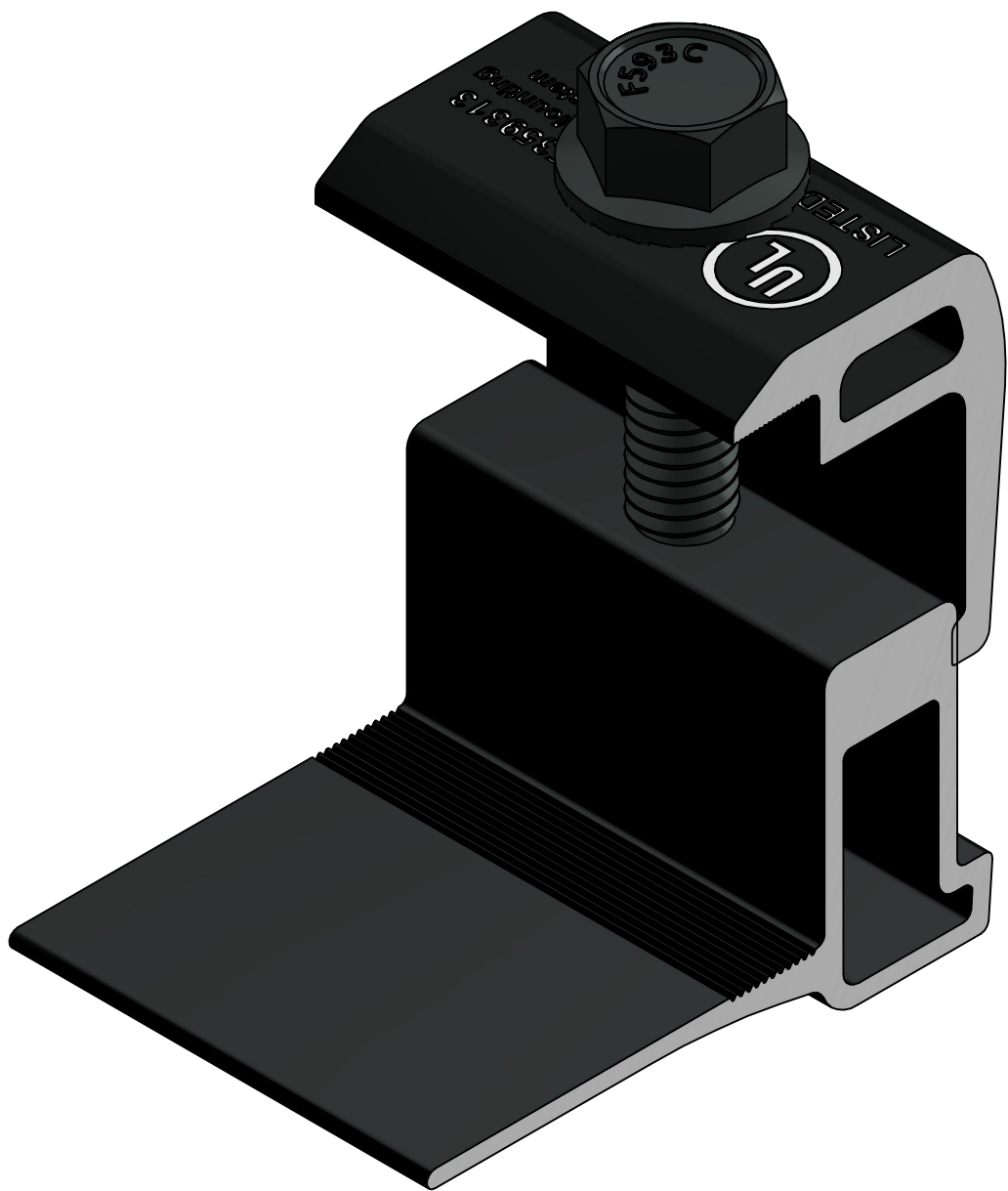

ISO

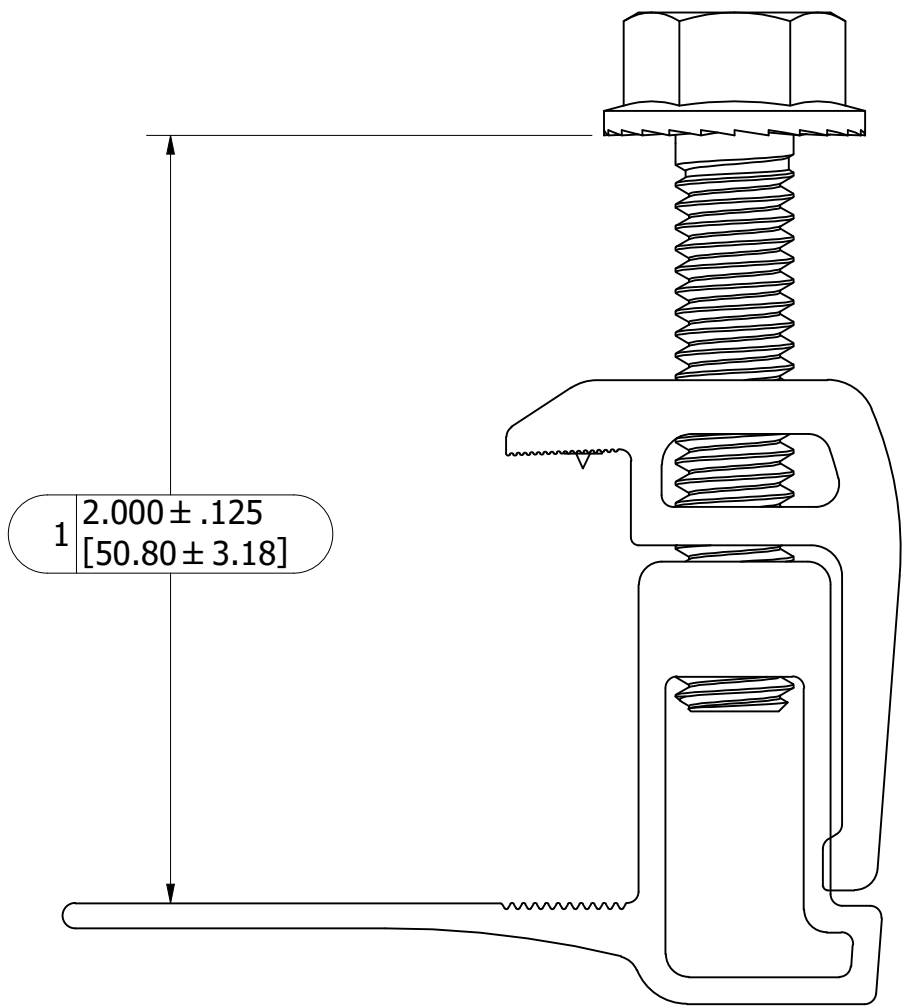

ASSEMBLY SPEC

PARTS LIST

ITEM	QTY	PART NUMBER	DESCRIPTION	REV
1	1	162-01102	BOLT, FLANGE SERRATED, 5-16IN-18 X 1-1-2IN, BLACK, SS	A
2	1	232-02065B	SNAPNRACK, ULTRA RAIL END CLAMP, TOP, BLACK	C
3	1	232-10070	SNAPNRACK, ADD-A-LIP BASE, BLACK	A

<div>SnapNrack™</div> <div>Solar Mounting Solutions</div>	SUNRUN INSTALLATION SERVICES INC.	DESIGNER: M.AFFENTRANGER	SHEET NUMBER: 1:1	SCALE: DNS	UNITS OF MEASURE: IN, LB, DEG [MM, KG, DEG]	DESCRIPTION: SNAPNRACK ADD-A-LIP	PART NUMBER: 242-01101	REV B
	225 BUSH STREET, SUITE 1400 • SAN FRANCISCO, CA. 94104 USA PHONE (877) 732-2860 • C@C@C@C.COM	DRAFTER: M.AFFENTRANGER	SHEET SIZE: C	DATE: 2/8/2023				
	THE INFORMATION IN THIS DRAWING IS CONFIDENTIAL AND PROPRIETARY. ANY REPRODUCTION, DISCLOSURE, OR USE THEREOF IS PROHIBITED WITHOUT THE WRITTEN CONSENT OF SNAPNRACK.	APPROVED BY: T.EDWARDS						

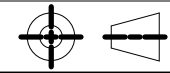

PART WEIGHT:
0.166 lbmass