

## Fronius Eco

EN

Spare parts list

Grid-connected inverter

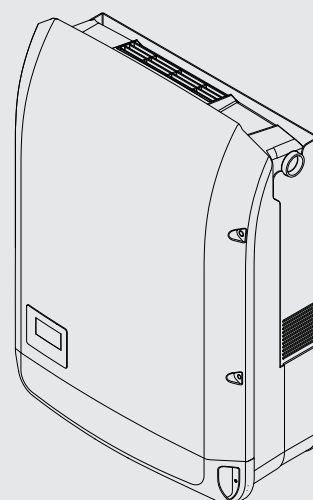

# Spare parts list: Fronius Eco

- Fronius Eco 25.0-3-S 4,210,056,040
- Fronius Eco 25.0-3-S light 4,210,056,041
- Fronius Eco 25.0-3-S Repl. 4,210,056,041A
- Fronius Eco 27.0-3-S 4,210,057,040
- Fronius Eco 27.0-3-S light 4,210,057,041
- Fronius Eco 27.0-3-S Repl. 4,210,057,041A

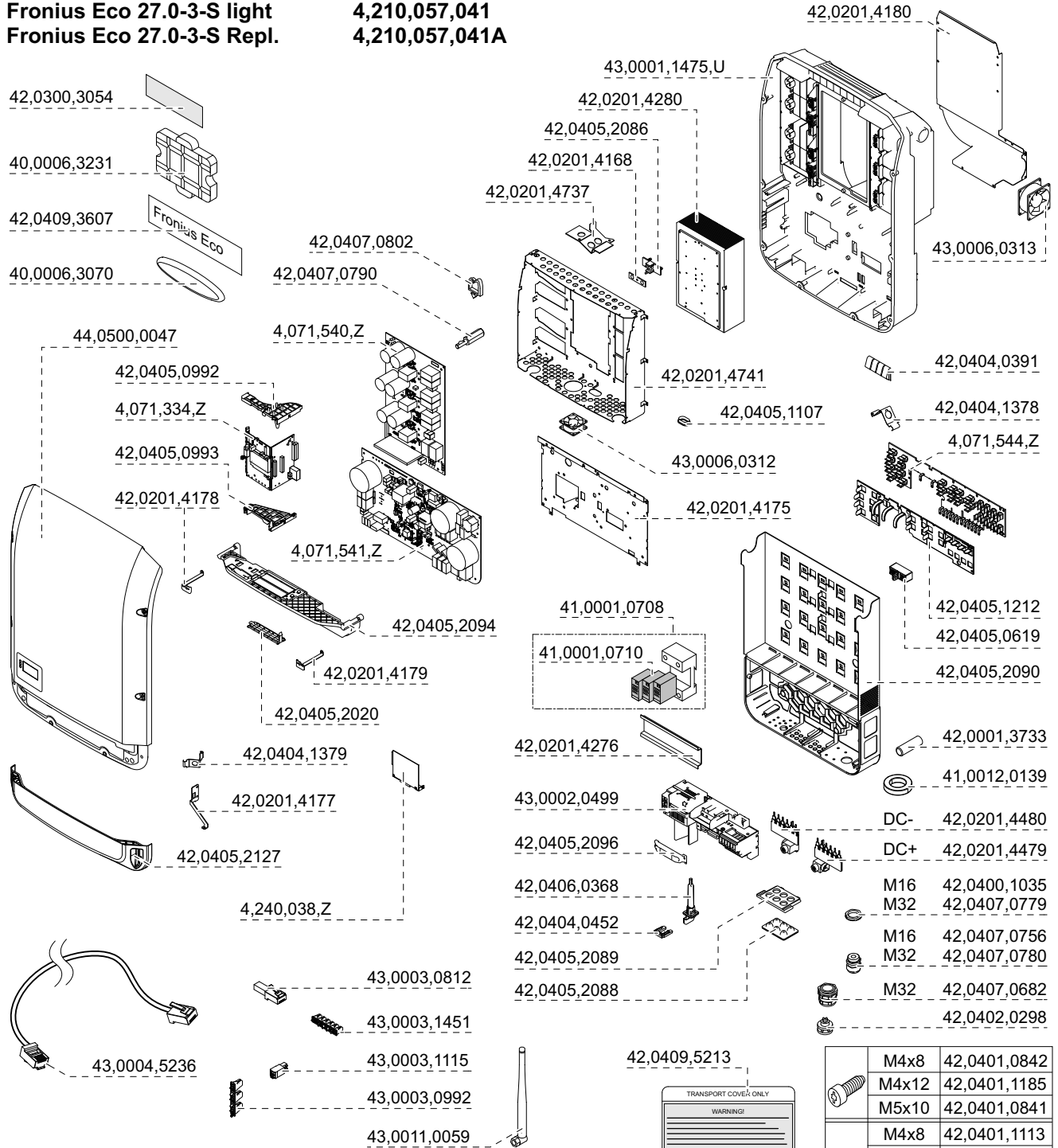

**REGISTER FOR FULL WARRANTY**  
<http://register.solarweb.com>

42,0409,3626



42,0409,5163

TRANSPORT COVER ONLY  
 ← 2,5 Nm / 1.84 ft. lb. →

42,0409,5212

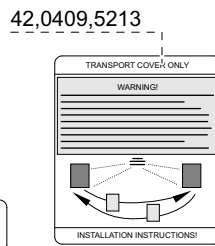

42,0409,5213

	M4x8	42,0401,0842
	M4x12	42,0401,1185
	M5x10	42,0401,0841
	M4x8	42,0401,1113
	M4x25	42,0401,1033
	M5x10	42,0401,1114
	M5x16	42,0401,1119
	M4x9	42,0401,1030
	M4x12	42,0407,0541
	Ø4mm	42,0407,0803
	15m4x3mm	42,0402,0311

40,0006,3283	Karton 3p10 785*560*327	2.90 BC / 39BC
40,0006,1360	Formteileinlage 3p10 vorne	561x200x320mm
40,0006,1361	Formteileinlage 3p10 hinten	561x200x320mm
40,0006,3070	Aufkleber FroniusLogo 150x41,6	F200
40,0006,3231	Blisterverpackung easy2B	Formteil
41,0001,0708	Übersp.Abl. DS50PVS-1000G/51	
41,0001,0710	Übersp.Abl. DSM50PV-1000G/51	
41,0012,0139	Ferritring lø35,5mm 4W1500	
42,0001,3733	Bolzen Ms 10x38mm	
42,0201,4179	Erdung Deckel rechts 3P10	
42,0201,4177	Erdung Datcom 3P10	
42,0201,4479	Phasenschiene DC+	z0122738
42,0201,4480	Phasenschiene DC-	z0122738
42,0201,4276	Hutschiene 35x7,5x110mm	
42,0201,4178	Erdung Deckel links 3P10	
42,0201,4175	EMV Blech FIL 3P10	
42,0201,4741	EMV Blech LT 3P27	
42,0201,4180	Luftleitkanal Blech 3P10	
42,0201,4168	Kupferschiene Lt.-Verb. Symo	
42,0201,4280	Kühlkörper 200x300x90mm	Kühlkörper Symo 20kW
42,0201,4737	Lüfterhalter 3P27	
42,0300,3054	Wärmeleitfolie TPC-Z200-PC	
42,0400,1035	Sechskantmutter M 16x1,5mm	Skintop GMP GL
42,0401,1185	Schraube PT 4x12 Torx Gr	PT ZnNi (DIN50962)
42,0401,1030	LINSENSCHRAUBE 4042 4x9	
42,0401,1033	Schraube PT 40x25mm vz	blau passiviert
42,0401,1119	Schraube 5x16 Torx Gr	Schraube [Gewindeformend]
42,0401,0841	TAPTITE SCHRAUBE M 5X10 GVZ	
42,0401,1113	Schraube PT 4x8 Torx Gr	Kunststoffschraube
42,0401,1114	Schraube PT 5x10 Torx Gr	Kunststoffschraube
42,0401,0842	TAPTITE-SCHRAUBE 4x8 GVZ	
42,0402,0298	Luftfilter Druckausg. Snapbar	Dichtung
42,0402,0311	Gummidichtung 15m4x3mm	
42,0404,0452	Halteclip f. DC Trenner	7LG8445
42,0404,1379	Druckfeder CuBe2 0,07x19mm vz	Federelement
42,0404,1378	Druckfeder EMV 0,3x29 CrNi18-8	
42,0404,0391	Kontaktfeder CuBe2 14,3x25,6mm	Federelement
42,0405,2096	Zugentlastungsbügel 3P10	Lexan3412R grau
42,0405,2090	Wandhalterung ROW	AlMg3 Lexan Resin 3412ECR
42,0405,2094	Datcomeinsatz 3P10	Frianyl-B63-V0
42,0405,2127	Datcomdeckel Symo 10-20kW	
42,0405,2089	DC-Dichtungshalter Symo	Valox 357XU
42,0405,2088	DC-Dichtung Symo	TPE TC6 FRZ
42,0405,2020	Blindstecker-Optionskarten	Valox 357XU RAL7016
42,0405,0619	Sicherungsaufnahme 8-fach	Frianyl B63 V0

42,0405,1212	Berührschutz ECO Fuse	NH 1015
42,0405,1107	Kabeldurchführung steckbar	45,7x28,6mm Pocan S7020
42,0405,0992	Recerbo Halterung hinten	
42,0405,0993	Recerbo Halterung vorne	
42,0405,2086	Kunststoffaufn. Lt-Verb.Symo	A3X2G5 sw/br
42,0406,0368	Griffeinheit DC Tren. 88,80	Versperrbar
42,0407,0780	Zugentlastung M32x1,5 KB 18-25	PA6
42,0407,0779	Sechskantmutter M32x1,5 sw	Polyamid PA/GF
42,0407,0682	Zugentlastung M32 Set Datcom	
42,0407,0541	Distanzbolzen DA7 M4x12 TX25MS	
42,0407,0803	Spreizniete ø4mm	PA6
42,0407,0756	Zugentlastung ST M M16x1,5mm	
42,0407,0790	Distanz SDI6 M3x22 sw Snapin	
42,0407,0802	Kabelbinder SnapIn	natur
42,0409,5213	Transport Cover Galvo Symo	Stripcal Laminat V
42,0409,3607	Aufkl. Beschriftung Eco	
42,0409,5163	Klebeetikette LS GALVO/SYMO	
42,0409,5212	Aufkleber Transport Cover u.	
42,0409,3626	Aufkl. Register Full Warranty	
42,0410,1909	BA Fronius Symo	Bedienungsanleitung
42,0410,2029	BA Fronius Symo 3-10 PICsSk	Bedienungsanleitung
42,0410,2027	BA Fronius Symo 3-10 EISvDa	Bedienungsanleitung
42,0410,2028	BA Fronius Symo 3-10 EntPb	Bedienungsanleitung
42,0410,2030	BA Fronius Symo 3-10 TrEsHu	Bedienungsanleitung
43,0002,0499	DC Tren 55A 4pol+AC 6pol ROW	
43,0003,1451	Steckverbinder 16pol 10A 300V	
43,0003,0992	Buchsenleiste 3pol. AWG 14-28	
43,0003,1115	Steckverbinder 2pol 15A 160V	
43,0003,0812	Stecker Abschlußkommunikation	RJ 45
43,0004,5236	Datenkabel 8pol 5m PVC bl. 1:1	
43,0006,0312	Axialluefter 06025SA-12N-ET	
43,0006,0313	Axialluefter 08038RA 12P GA 01	
43,0011,0059	Antenne GW.40.2153	
44,0500,0047	Frontpanel Symo 10-20kW	
4,071,334,Z	PRINT RECERBO tested	Replacement PCB Fronius
4,071,540,Z	PRINT ECOAC27 tested	Replacement PCB Fronius ECO
4,071,541,Z	PRINT ECOFIL27 tested	Replacement PCB Fronius ECO
4,071,544,Z	PRINT ECOFUSE tested	Replacement PCB Fronius ECO
4,240,038,Z	Datamanager2.0 WLAN GalSymPrim	
43,0001,1475,U	Gehäuse & Induktion ECO	

40,0006,3283	Carton 3p10 775x575x30	Reserved
40,0006,1360	Moulded part insert 3p10 front	561x200x320mm
40,0006,1361	Moulded part insert 3p10 rear	561x200x320mm
40,0006,3070	FroniusLogo sticker 150x41.6	F200
40,0006,3231	Blister pack easy2b	Moulded part
41,0001,0708	Surge arrest. DS50PVS-1000G/51	reserved
41,0001,0710	Surge arrest. DSM50PV-1000G/51	
41,0012,0139	Ferrite ring lø35,5mm 4W1500	
42,0001,3733	Bolt Ms 10x38mm	
42,0201,4179	Earthing cover right 3P10	
42,0201,4177	Earthing DatCom 3P10	
42,0201,4479	Busbar DC+	z0122738
42,0201,4480	Busbar DC-	z0122738
42,0201,4276	Top hat rail 35x7,5x110mm	
42,0201,4178	Earthing cover left 3P10	
42,0201,4175	EMC plate FIL 3P10	
42,0201,4741	EMC plate LT 3P27	
42,0201,4180	Air guide plate 3P10	
42,0201,4168	CU rail LT conn. 3P10	
42,0201,4280	Profilmecc Plus 200x300x90mm	
42,0201,4737	Fan holder 3P27	
42,0300,3054	Thermal foil	
42,0400,1035	Hexagon nut M 16x1.5mm	Skintop GMP GL
42,0401,1185	Screw PT 4x12 Torx grey	PT ZnNi (DIN50962)
42,0401,1030	CHEESE-HEAD SCREW 4042 4x9	
42,0401,1033	Screw PT 40x25mm vz	blue passivated
42,0401,1119	Screw 5x16 Torx gr	Screw [self-tapping]
42,0401,0841	SCREW EXTRUDE-TITE 5X10 GVZ	
42,0401,1113	PT screw 4x8 Torx gr	Plastic screw
42,0401,1114	Screw PT 5x10 Torx grey	Plastic screw
42,0401,0842	SCREW EXTRUDE-TITE 4X8 GVZ	
42,0402,0298	Air filter press.adj. Snapbar	Seal
42,0402,0311	Rubber seal 15m4x3	
42,0404,0452	Retaining clip for DC discon.	7LG8445
42,0404,1379	Compr. spr. CuBe2 0.07x19mm gv	Spring element
42,0404,1378	Compr. spr.EMC 0.3x29 CrNi18-8	
42,0404,0391	Cont. spring CuBe2 14.3x25.6mm	Spring element
42,0405,2096	Strain-relief bow 3P10	Z0122679
42,0405,2090	Wall holder ROW	z0125730
42,0405,2094	Datcom insert 3P10	Z0130118
42,0405,2127	Cover Datcom Symo 10-20kW	
42,0405,2089	DC seal holder 3P10	z0125420
42,0405,2088	DC seal 3P10	z0125436
42,0405,2020	Blanking plug option cards	z0124540
42,0405,0619	Fuse holder 8-fold	

42,0405,1212	Protection against contact Fus	NH 1015
42,0405,1107	Cable gland, plug-in	45.7x28.6mm
42,0405,0992	Recerbo holder rear	
42,0405,0993	Recerbo holder front	
42,0405,2086	LT. connector plastic	z0127936
42,0406,0368	Switch lever Row 3P 10-20 sw	
42,0407,0780	Strain relief M32x1.5 18-25 KB	PA6
42,0407,0779	Hexagon nut M32x1.5 bk	Polyamide PA/GF
42,0407,0682	Strain relief M32 set DatCom	
42,0407,0541	Bolt DA7 M4x12 MS	
42,0407,0803	Expanding rivet ø4mm	
42,0407,0756	Strain-rel.dev. ST M M16X1.5mm	
42,0407,0790	Spacer SDI6 M3x22 sw Snapin	
42,0407,0802	Binder SnapIn	
42,0409,5213	Transport Cover Galvo Symo	Stripcal laminate V
42,0409,3607	Eco lettering sticker	
42,0409,5163	Sticker LS Galvo/Symo	
42,0409,5212	Sticker Transport Cover lower	
42,0409,3626	Register Full Warranty sticker	
42,0410,1909	OI Fronius Symo	Operating instructions
42,0410,2029	OI Fronius Symo 3-10 PICsSk	Operating instructions
42,0410,2027	OI Fronius Symo 3-10 EISvDa	Operating instructions
42,0410,2028	OI Fronius Symo 3-10 EnItPb	Operating instructions
42,0410,2030	OI Fronius Symo 3-10 TrEsHu	Operating instructions
43,0002,0499	DC isol 55A 4pol+AC 6pol ROW	
43,0003,1451	Plug connect. 16-pin 10A 300V	
43,0003,0992	Socket board 3-pin AWG 14-28	
43,0003,1115	Plug connection 2-pin 15A 160V	
43,0003,0812	Plug for final communication	RJ 45
43,0004,5236	8-pin data cable 5m PVC bl 1:1	
43,0006,0312	Axial fan 06025SA-12N-ET	
43,0006,0313	Axial fan 08038RA 12P GA 01	
43,0011,0059	Antenna GW.40.2153	
44,0500,0047	Front panel Symo 10-20kW	
4,071,334,Z	PRINT RECERBO tested	Replacement PCB Fronius
4,071,540,Z	PC board ECOAC27 tested	
4,071,541,Z	PC board ECOFIL27 tested	
4,071,544,Z	PC board ECOFUSE tested	
4,240,038,Z	Datamanager2.0 WLAN GalSymPrim	
43,0001,1475,U	Housing & induction ECO	



# Fronius Worldwide - [www.fronius.com/addresses](http://www.fronius.com/addresses)

**Fronius International GmbH**  
4600 Wels, Froniusplatz 1, Austria  
E-Mail: [pv-sales@fronius.com](mailto:pv-sales@fronius.com)  
<http://www.fronius.com>

**Fronius USA LLC** Solar Electronics Division  
6797 Fronius Drive, Portage, IN 46368  
E-Mail: [pv-us@fronius.com](mailto:pv-us@fronius.com)  
<http://www.fronius-usa.com>

Under <http://www.fronius.com/addresses> you will find all addresses of our sales branches and partner firms!